

Model: PRIPORT RUBY		Date: 12-Oct-04	No: M-C232-002
Modified Article: Paper Guide		Prepared by:	
From: Priport Service Planning Section		A. Yoshida	
Classification:	<input type="checkbox"/> Parts catalog correction	<input type="checkbox"/> Vendor change	<input type="checkbox"/> To meet standards
	<input type="checkbox"/> To facilitate assembly	<input checked="" type="checkbox"/> To improve reliability	()
	<input type="checkbox"/> Part standardization	<input type="checkbox"/> Other ()	
Model Name:			
Ricoh JP5800			

The following applies to the optional JS40-Sorter.

Old #	New #	Description	Qty	Int	Page	Index
-	C5922370	Front Guide Assembly	1	X/O as a set	21	*24
-	C5922371	Rear Guide Assembly	1		21	*25
-	04514006B	Tapping Screw – 4x6	2		21	101
-	C5922374	Guide	2	-	21	*26

*: New index

NOTE: The #C5922374 guide is part of the front guide assembly and rear guide assembly.

Change: Added front guide assembly [A], rear guide assembly.

Reason: To ensure that curled paper is fed smoothly in the relay transport area [B] and horizontal transport area [C].

Important: When images with many solid image areas are printed out often, light scratches can appear on the copy. For these customers, attach a piece of double-sided tape [D] to the guide assembly, and then attach the guide assembly to the upper stay [E].

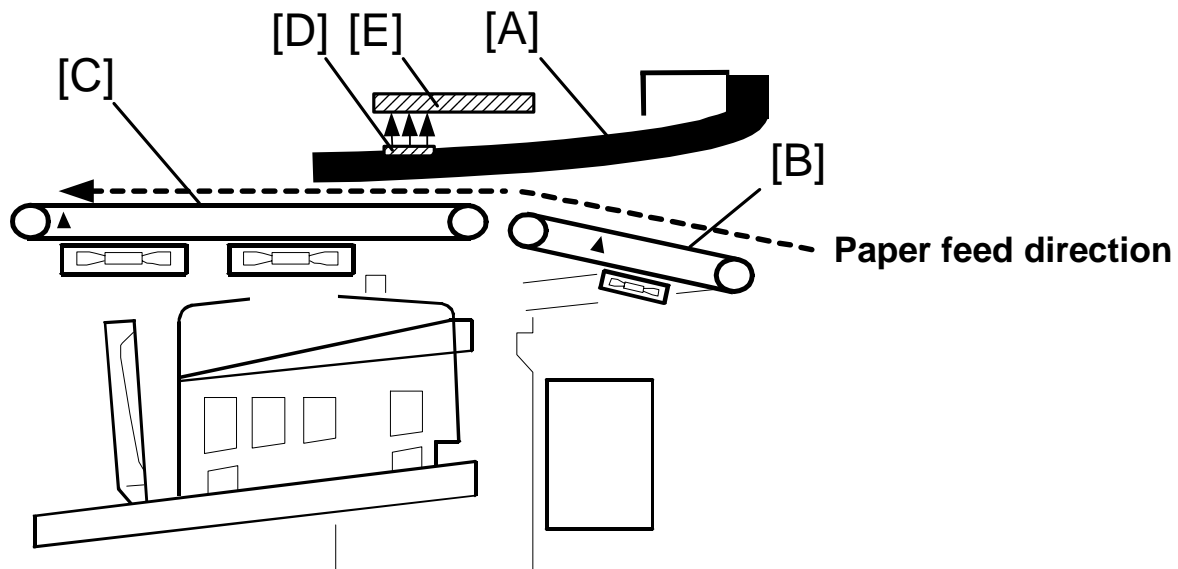

Model: PRIPORT RUBY**Date:** 12-Oct-04**No:** M-C232-012

Revised Illustration:

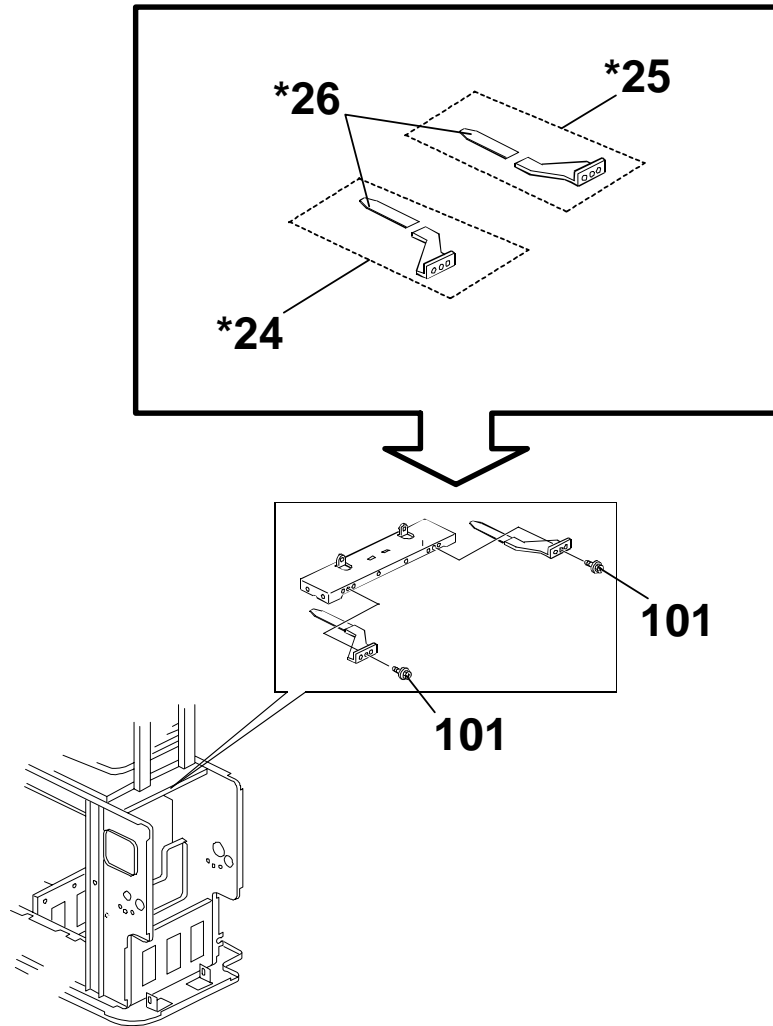
**CUT IN SERIAL NUMBERS**

Model Name	V/Hz	Destination	Code	Serial Number
JS40-Sorter	230/50	Europe	C592-53	C3881080001

Model: PRIPORT RUBY	Date: 3-Dec-04	No: M-C232-003
Modified Article: Belt drive motor	Prepared by:	
From: Priport Service Planning Section	M. Kanomata	
Classification:	<input type="checkbox"/> Parts catalog correction <input type="checkbox"/> Vendor change <input type="checkbox"/> To meet standards <input type="checkbox"/> To facilitate assembly <input checked="" type="checkbox"/> To improve reliability () <input type="checkbox"/> Part standardization <input type="checkbox"/> Other ()	
Model Name:		
Ricoh JP5600		

This MB applies to the optional **JS40-Sorter**.

Old #	New #	Description	Qty	Int	Page	Index
C5925868	C5925869	BELT DRIVE MOTOR	1	X/O	7	21

Change: The internal connection of the harness and motor was changed.

Reason: To ensure that the harness stays connected to the motor. This will ensure that a jam at the relay transport unit does not occur.

Illustrations:

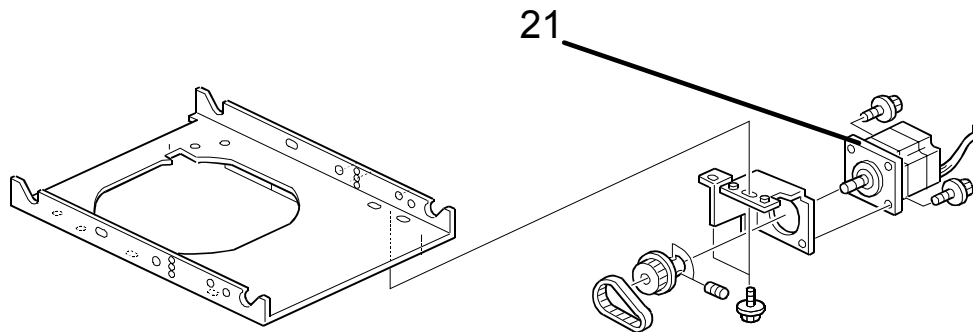

[A]: Internal connection point of the harness.

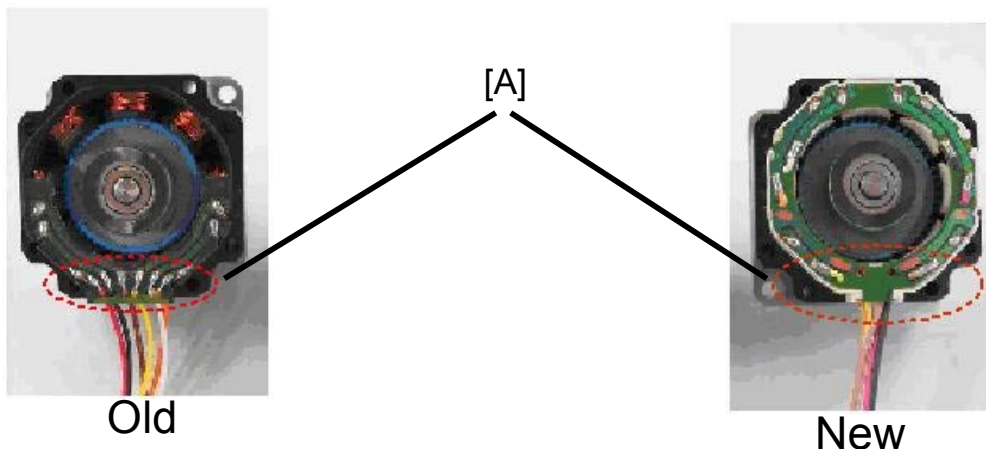

Model: PRIPORT RUBY**Date:** 3-Dec-04**No:** M-C232-003**CUT IN SERIAL NUMBERS**

Model Name	V/Hz	Destination	Code	Serial Number
JS-40 Sorter	230/50	Europe	C592-53	C3384090001